

Morwell Park P S

School Community Newsletter

76-82 Vary St, MORWELL. 3840
Ph. 5134 1793, Fax 5134 8465.
email - morwell.park.ps@edumail.vic.gov.au
www.morwellparkps.vic.edu.au

30th January, 2015



Morwell Park Primary
School Official

IMPORTANT DATES TO REMEMBER

Thursday	5th February	Family BBQ & Games Night. 5.30 - 6.30pm.
Friday	6th February	Deposit due for Grade 6 Waratah Bay Camp.
Friday	13th February	Permission, Medical & Behaviour Forms due back for Waratah Bay Camp.
Thursday	19th February	Final payment due for Waratah Bay Camp.
Tuesday-Friday	24th-27th	Waratah Bay Camp.

Principal's Report

Welcome Welcome to the start of the 2015 school year, I look forward to another exciting and rewarding year ahead. To our Prep students a big welcome to school. It's a big stage in life finally starting school and very soon all those little anxieties will fade away (speaking to some this morning if there were any they've already gone) and very soon school will feel like a second home. During the month of February our Preps do not attend school on Wednesdays, however they are rostered for individual appointments where they participate in academic tests to allow the Prep teachers an indication of entry level.

I would also like to welcome Casey McMillan our new grade one teacher. Casey worked at our school as an intern last year in the grade 2/3 classes and we liked her so much we kept her on! I wish her a wonderful career ahead.

Anaphylaxis We have a student in our school who has a severe anaphylactic reaction to nuts (**severe as in life threatening**). While I am not seeking to put a blanket ban on all nut products which would be almost impossible, I do ask that parents seek to reduce the amount of products that may contain nuts – particularly peanuts, peanut butter and Nutella. We do not offer nut based products in our breakfast program, cooking classes etc and we will be requiring students who do have nut products to be vigilant.

Family Sausage Sizzle Next Thursday we will having a family Sausage Sizzle from 5.30 – 6.30 where parents will be able to meet their child's teacher and visit classrooms. We will be having a number of informal games around the school where children and parents will be able to join in. The evening will be very informal and is an opportunity for children to show their parents around our school. Sausages and drinks will be provided from the classrooms.

Grade Structure

(FLT Prep) **Prep** – Stephanie Wilson, Courtney Garth & Kaitlyn Duffus. (Rooms: 23 and 24)

(FLT 1) **Gr 1** – Anne Evans (Rm 19), Ann Mills (Rm 21). Casey McMillian (Rm 22).

(FLT 2/3) **Gr 2/3** – Allan Johnson (Rm 2), Nella Mangiafico & Deb Jones (Rm 3), Angie Lane (Rm 6), Maria Demetriou (Rm 9).

(FLT 4-6) **Gr 4** – Claire Allison (Rm16), Melissa Graham (Rm 17)
Gr 5/6 – Lisa VanRooy (Rm 13), Marlee Hillier (Rm14), Alan Stewart (Rm 15)

FLT = Flexible Learning Teams
School Map included in the newsletter.

Inverloch Beach Excursion

One of the highlights of the school year last year for many children was the trip to Inverloch. We will once again be holding this trip on Friday February 13. The trip will be free however permission returns are essential. We also welcome parents to attend pending availability on buses.

Traffic around the school:

As school has resumed we all need to be extra careful and responsible around our neighbourhood. Driving or walking to and from school should be done in a manner that models the care and responsibility adults have in this regard. Remind your children about the following:

- When riding bicycles and/or scooters to school wear the approved helmet and ride in an alert and responsible manner,
- When walking to school, stick to the paths, use school crossings and be alert to traffic and others.
- Bikes, skateboards, rollerblades and scooters are not to be ridden in the school grounds.

Asthma management plans:

I would encourage all families who have children with asthma to have their asthma management plans updated by their doctor and provided sent school.

We all want the appropriate asthma treatment for your child should they experience an attack, but we need to have that information clear from you and your doctor.

Chris Joustra,

Principal.

VARY STREET EXIT

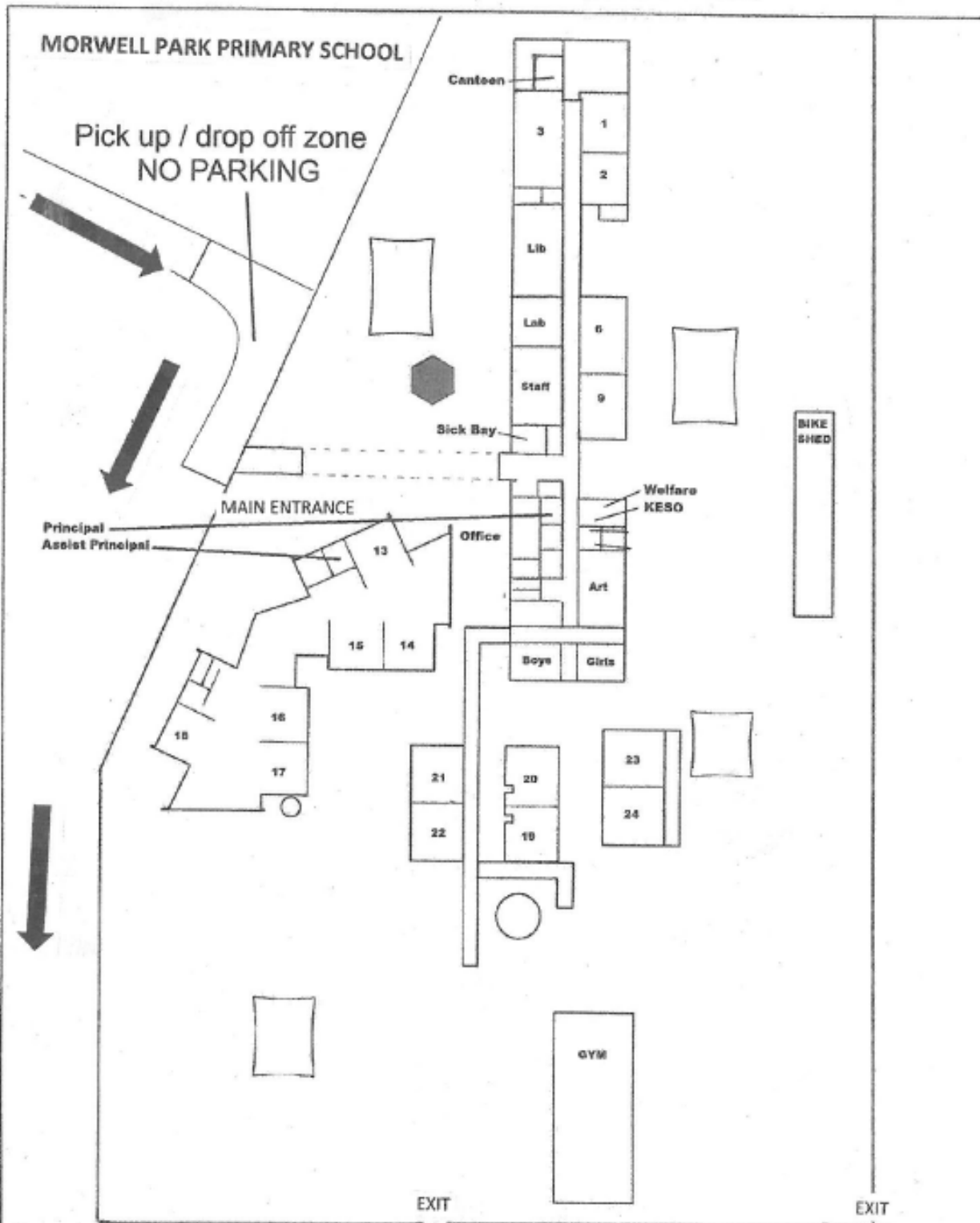

PARKING

PARKING





MORWELL PARK PRIMARY SCHOOL

2015 Year Planner - Camps, Excursions and Activities etc

Month	Date	Grade	Activity	Approx \$
Term 1 29th January - 27th March				
February	5th		Family Night	
	11th	4, 5 & 6	Otto Ford Swim Carnival - selected students	\$4.00
	13th	P - 6	Inverloch Excursion	
	24th - 27th	6	Waratah Bay Camp	\$100.00
	26th		Division Swimming Sports at Traralgon Pool	\$3.80
March	6th	1 - 6	Mirboo Nth Pool	\$5.50
	12th		Region Swimming	\$3.00
	13th	3 & 4	Netball Tournament	
	20th-22nd	6	HPV Wonthaggi	
Term 2 13th April - 26th June				
April	15th	P - 6	Morwell Park Athletics	
	22nd		Grip Leadership Conference JSC members	
	28th -6th May	5 & 6	Somers Camp	\$210.00
	29th	Prep	Park Excursion / Autumn Walk	\$3.00
May	5th	P - 6	Alpha Show "Hercules"	\$7.00
	12th-14th	3 & 5	NAPLAN	
	15th	4, 5 & 6	District Cross Country	\$1.00
	18th	5 & 6	District Football	
	20th	P - 6	Walhalla Excursion	
	29th	5 & 6	District Soccer	\$2.00
June	4th	3 - 6	Division Cross Country	\$2.00
	5th	5 & 6	Bessie Frod Netball Tournament	
	5th-8th	P - 6	Life Ed Van	
	16th		Division Winter Sports	\$3.00
	18th		Region Cross Country	\$2.00
	22nd-26th	5	Woorabinda Camp	\$185.00
Term 3 13th July - 18th September				
July	20th-24th	1 - 3	Swimming Program	\$20.00
	22nd		Region Winter Sports	\$2.00
August	12th	4, 5 & 6	District Athletics	\$3.00
	12th	Prep	Coal Creek Historical Park	\$20.00
	21st	1	Melbourne Museum	\$25.00
	27th	6	District Basketball	\$3.00
September	1st	6	Division Basketball	\$3.00
	3rd	P - 6	School Photos	
	8th	4 - 6	Division Athletics	\$2.50
Term 4 5th October - 18th December				
October	13th	4 - 6	Region Athletics	\$2.50
	19th-21st	3	Munjarra Camp	\$130.00
	21st-23rd	4	Munjarra Camp	\$130.00
	23rd	Prep	Zoo Trip	\$35.00
	27th	P - 6	Nexus Show "We Love Rock n Roll"	\$6.00
		6	P.E Camp Rawson	\$200.00
November	18th - 22nd	6	Melbourne One Day Fun Day	\$50.00
		5 & 6	HPV, Maryborough	
December	2nd - 3rd	P	Swimming Program	\$10.00
	11th	6	Transition Lunch	
	16th	P - 6	Glen Cromie Park	\$5.00

Please Note:

* All excursion dates are still to be confirmed.

* Camp dates are already booked.

* Shows are to be conducted at school.

* Additional 'small cost' programs may be included during 2014 as we are notified of their availability.

CANTEEN LUNCH ORDERS

At this stage we hope the canteen will be open for lunch orders Monday & Friday commencing 2nd March. Deb Minster (past parent, current grandparent) will coordinate the canteen with the help of willing volunteers. If you can offer your time on a regular basis please complete your details below to enable the roster to be drawn up.

8.45 – 10.30 to write up and collate orders
10.30 – 1.30 to prepare lunches for delivery to the classroom.

Please indicate your preferred day/time, remembering that your offer to volunteer on the roster would be a regular commitment.

Monday Friday
 8.45 – 10.30 10.30 – 1.30
 Weekly Fortnightly Monthly

Name _____

Phone _____

Eldest Child _____ Grade _____

Location, location, location:

One of the initial things that parents new to a school often find difficult is the location of features of the school relevant to them. Included in this newsletter is a map of the school and surrounds which may prove handy for those new to MPPS and for those parents whose children have changed rooms within the school.

The map also highlights relevant locations such as entry/exits, main office, sick bay, canteen and of course the office of the Principal. Importantly the map also gives a broad indicator of vehicular traffic flow in and around the school. This is particularly important for all of us to remember as cars and kids can at times be a dangerous mix.

In a nut shell, vehicular traffic may enter from Hourigan Road into the ONE WAY service road that accesses the car parking and main entrance to the school. There is also a specified drop off and pick up zone which allows parents to pull in and drop off or collect their children. However this is not a parking bay as such and is designed to allow for a flow of traffic through this area. (Parking and then leaving your vehicle unattended could incur a fine through the local by-laws system).

Parking is available along the service road in marked locations but please be aware that there will be parents and children walking in these areas before and after school. DRIVE SLOWLY WITH CARE AND BE ALERT.

Limited parking is also available in Vary Street but be conscious of the town bus collection point and signage indicating restrictions in other areas of the street. Again DRIVE SLOWLY WITH CARE AND BE ALERT.

Finally we have numerous teachers on duty in various locations before and after school to ensure the safety of your children. (Many schools aren't able to provide such a service). Please respect the job they are doing for your benefit.

MORWELL PARK 2015 STAFF

Chris Joustra	Principal
Peter Credlin	Assist Principal
Kaitlin Duffus	Prep-Rm 23/24
Stephanie Wilson	
Courtney Garth	
Anne Evans	1E – Rm 19
Ann Mills	1M – Rm 21
Casey McMillian	1G – Rm 22
Allan Johnson	2/3A – Rm 2
Nella Mangiafico	2/3M – Rm 3
Deb Jones	2/3J—Rm 3
Angie Lane	2/3L – Rm 6
Maria Demetriou	2/3D – Rm 9
Claire Allison	4A – Rm 16
Melissa Graham	4G – Rm 17
Lisa Van Rooy	5/6V – Rm 13
Marlee Hillier	5/6H – Rm 14
Alan Stewart	5/6S - Rm 15
Pauline Little	Maths Tchr
Adrian Quirk	DAI/IT
Julie Grummisch	Phys Ed
Kiarna Oowler	Art Room
Michelle Foster	Koorie Literacy
Barb Wiegandt	German
Randall Cruickshank	OHS
Kate Morehouse	Jnr Literacy
Pauline Tantau	Business Mgr
Debbie Campbell	Administration
Hiba Abdalla	ESL Aide
Terry Burgess	Koorie Ed
Raylene Palmer	DAI/Welfare
Janet Glen	Integration Aide
Sharon DiMaria	Integration Aide
Heather Brewer	Integration Aide
Donna Maruzza	Integ Aide/Lib
Sharon Berend	Integration Aide