

Morwell Park P S

School Community Newsletter

76-82 Vary St, MORWELL. 3840
Ph. 5134 1793, Fax 5134 8465.
email - morwell.park.ps@edumail.vic.gov.au
www.morwellparkps.vic.edu.au

30th January 2014



Morwell Park Primary
School Official

IMPORTANT DATES TO REMEMBER

Friday	7th February	Deposit due for Grade 6 Waratah Bay Camp.
Friday	14th February	Permission, Medical & Behaviour Forms due back for Waratah Bay Camp.
Thursday	20th February	Final payment due for Waratah Bay Camp.
Thursday	20th February	Family BBQ & Games Night. 6.00 - 7.00pm.
Tuesday-Friday	25th-28th February	Grade 6 Waratah Bay Camp.
Friday	28th February	EMA applications close.

Principal's Report

Welcome

Welcome back to school for all of our returning students and welcome to school for all of our Prep and new students. I hope that everyone enjoyed the summer break, it is terrific to see all of our enthusiastic students and I trust that an enjoyable and productive school year ahead awaits us all. I have been extremely impressed with the smooth start to the school year. Teachers have spent many days over the school break preparing for their new grades and this effort has resulted in a terrific start to the year.

Anaphylaxis

We have a student in our school who has a severe anaphylactic reaction to nuts (**severe as in life threatening**). While I am not seeking to put a blanket ban on all nut products which would be almost impossible, I do ask that parents seek to reduce the amount of products that may contain nuts – particularly peanuts, peanut butter and Nutella. We will no longer be offering nut based products in our breakfast program, cooking classes etc and we will be requiring students who do have nut products to be vigilant.

Family BBQ and Games Night

On Thursday February 20 we will be having a family BBQ and games night from 6pm to approximately 7(ish)pm. This will give children an opportunity to show their parents / family members their classroom, introduce their teacher then participate in a number of different games and activities. A free sausage sizzle will be available including drinks and icy poles. The evening will be quite informal and will provide a chance for parents to meet teachers and join in games with their children. More details will follow in next week's newsletter. Mr Credlin has named it our '**View, Chew and Do Night !!!**'

Grade Structure

- (FLT Prep) **Prep** – Debbie Jones, Nella Mangiafico, Kaitlyn Duffus. (Rooms: 23 and 24)
- (FLT One) **Gr 1** – Anne Evans (Rm 19), Melissa Graham (Rm 22), Ann Mills (Rm 21).
- (FLT 2/3) **Gr 2/3** – Randall Cruickshank & Lisa VanRooy (Rm 9), Marlee Hillier (Rm 6), Luke Haustorfer (Rm 3), Stephanie Wilson (Rm 3), Maria Demetriou & Allan Johnson (Rm 2).
- (FLT 4-6) **Gr 4/5** – Alan Stewart (Rm15), Joy Fitzgerald & Julie Grummisch (Rm 13) Angie Lane (Rm 14)
Gr 6 – Claire Allison (Rm 16), Adam Bailey.(Rm 17)

FLT – Flexible Learning Teams
School Map included in the newsletter.

Hats

A reminder that Morwell Park is a Sunsmart School and as such all children are required to wear hats whilst in the yard. A number of children have been relying on borrowing hats however all children are required to have their own school hat so if your child does not yet have a hat please purchase one from LOWES at Mid Valley, or arrange a suitable wide brimmed alternative until this can be done.

Chris Joustra, Principal.

School hats are currently NOT available at the office, but may be purchased from LOWES at Mid Valley, Morwell.

CANTEEN LUNCH ORDERS

At this stage we hope the canteen will be open for lunch orders Monday & Friday commencing 3rd March. Deb Minster (past parent, current grandparent) will coordinate the canteen with the help of willing volunteers. If you can offer your time on a regular basis please complete your details below to enable the roster to be drawn up.

8.45 – 10.30 to write up and collate orders
10.30 – 1.30 to prepare lunches for delivery to the classroom.

Please indicate your preferred day/time, remembering that your offer to volunteer on the roster would be a regular commitment.

Monday Friday
 8.45 – 10.30 10.30 – 1.30
 Weekly Fortnightly Monthly

Name _____

Phone _____

Eldest Child _____ Grade _____

Location, location, location:

One of the initial things that parents new to a school often find difficult is the location of features of the school relevant to them. Included in this newsletter is a map of the school and surrounds which may prove handy for those new to MPPS and for those parents whose children have changed rooms within the school.

The map also highlights relevant locations such as entry/exits, main office, sick bay, canteen and of course the office of the Principal. Importantly the map also gives a broad indicator of vehicular traffic flow in and around the school. This is particularly important for all of us to remember as cars and kids can at times be a dangerous mix.

In a nut shell, vehicular traffic may enter from Hourigan Road into the ONE WAY service road that accesses the car parking and main entrance to the school. There is also a specified drop off and pick up zone which allows parents to pull in and drop off or collect their children. However this is not a parking bay as such and is designed to allow for a flow of traffic through this area. (Parking and then leaving your vehicle unattended could incur a fine through the local by-laws system).

Parking is available along the service road in marked locations but please be aware that there will be parents and children walking in these areas before and after school. DRIVE SLOWLY WITH CARE AND BE ALERT.

Limited parking is also available in Vary Street but be conscious of the town bus collection point and signage indicating restrictions in other areas of the street. Again DRIVE SLOWLY WITH CARE AND BE ALERT.

Finally we have numerous teachers on duty in various locations before and after school to ensure the safety of your children. (Many schools aren't able to provide such a service). Please respect the job they are doing for your benefit.

MORWELL PARK STAFF 2014

Chris Joustra	Principal
Peter Credlin	Assist Principal
Kaitlin Duffus	Prep-Rm 23/24
Nella Mangiafico	
Debbie Jones	
Anne Evans	1E – Rm 19
Ann Mills	1M – Rm 21
Melissa Graham	1G – Rm 22
Maria Demetriou	2/3D – Rm 2
Allan Johnson	2/3D – Rm 2
Luke Haustorfer	2/3L – Rm 3
Marlee Hillier	2/3M – Rm 6
Lisa Van Rooy	2/3V – Rm 9
Randall Cruickshank	2/3V – Rm 9
Stephanie Wilson	2/3W – Rm 3
Joy Fitzgerald	4/5F – Rm 13
Angie Lane	4/5L – Rm 14
Alan Stewart	4/5S - Rm 15
Claire Allison	6A – Rm 16
Adam Bailey	6B – Rm 17
Pauline Little	Maths Tchr
Adrian Quirk	DAI/IT
Julie Grummisch	Phys Ed
Kiarna Owler	Art Room
Michelle Foster	Koorie Literacy
Barb Wiegandt	German
Pauline Tantau	Business Mgr
Debbie Campbell	Administration
Hiba Abdalla	ESL Aide
Terry Burgess	Koorie Ed
Raylene Palmer	DAI/Welfare
Janet Glen	Integration Aide
Sally Malcolmson	Integration Aide
Christine Hardy	Integration Aide
Sharon DiMaria	Integration Aide
Heather Brewer	Integration Aide
Donna Maruzza	Integ Aide/Lib
Sharon Berend	Integration Aide

VARY STREET EXIT

MORWELL PARK PRIMARY SCHOOL

Pick up / drop off zone
NO PARKING

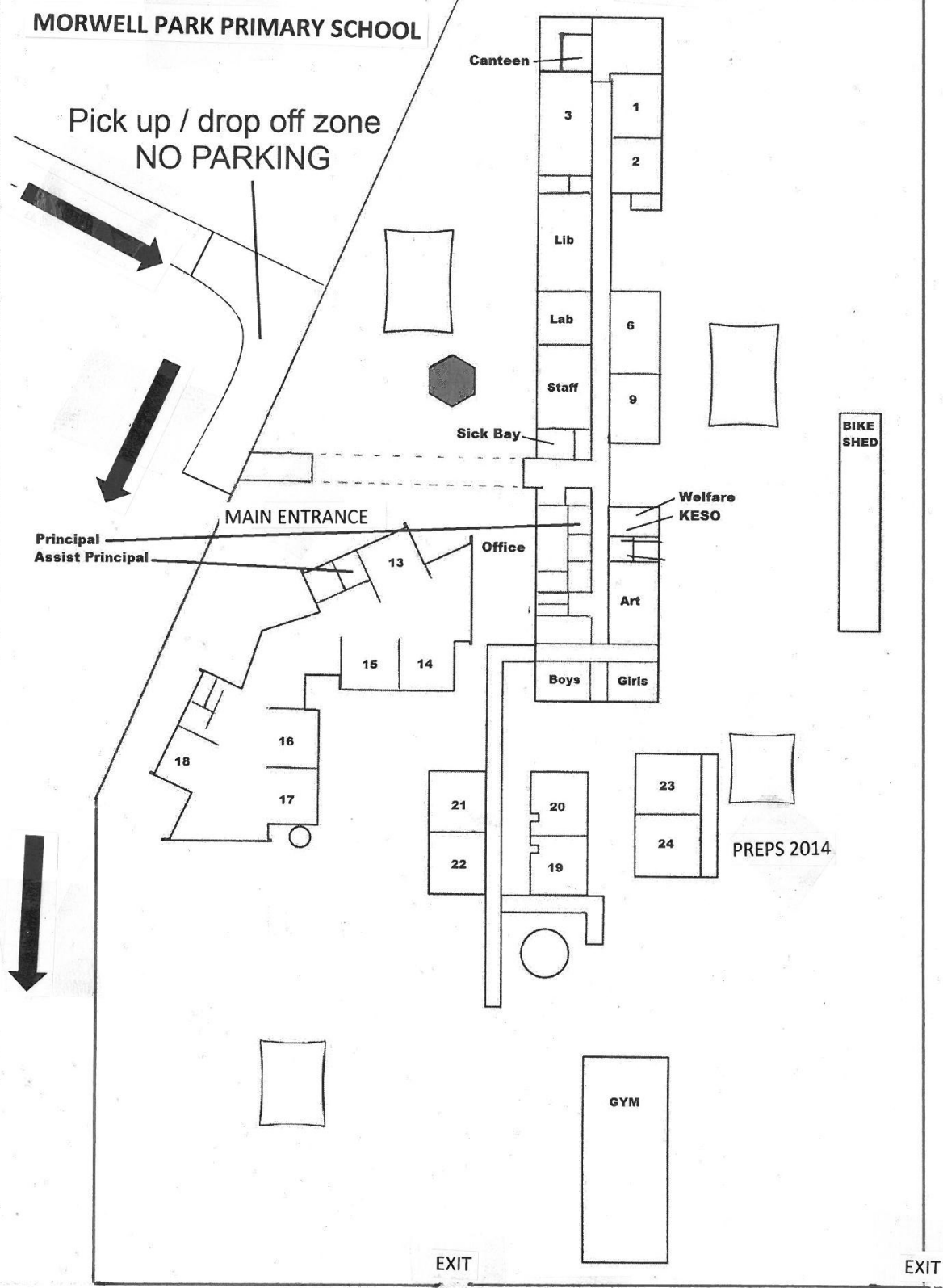

BIKE SHED

PREPS 2014

EXIT

EXIT

PARKING

PARKING





MORWELL PARK PRIMARY SCHOOL

2014 Year Planner - Camps, Excursions and Activities etc

Month	Date	Grade	Activity	Approx \$
Term 1 28th January - 4th April				
February	12th	4, 5 & 6	Otto Ford Swim Carnival - selected students	\$4.00
	20th		Family BBQ & Games Night	
	25th - 28th	6	Waratah Bay Camp	\$95.00
	26th		Division Swimming Sports at Traralgon Pool	\$3.80
March	5th	1 - 6	Mirboo Nth Pool	\$5.50
	12th		Region Swimming	\$3.00
	14th	3 & 4	Netball Tournament	
	17th		Harmony Week	
	20th		Harmony 8's Cricket Traralgon - selected students	
	21st - 23rd	6	HPV Wonthaggi	
Term 2 22nd April - 27th June				
April		Prep	Park Excursion / Autumn Walk	\$2.00
		P - 6	Morwell Park Athletics	
		1 - 3	Swimming Program	\$25.00
May	8th	P - 6	School Athletics at Newborough	
	9th	4, 5 & 6	District Cross Country	\$1.00
	13th - 15th	3 & 5	NAPLAN	
	19th - 23rd	5	Woorabinda Camp	\$180.00
	19th - 23rd		Education Week	
	20th	P - 6	Alpha Show "Cinderella"	\$7.00
	27th	5 & 6	District Football	
	30th	5 & 6	District Soccer	\$2.00
June	5th	3 - 6	Division Cross Country	\$2.00
	6th	5 & 6	Bessie Frod Netball Tournament	
	5th - 12th	P - 6	Life Ed Van	
	17th		Division Winter Sports	\$3.00
	19th		Region Cross Country	\$2.00
Term 3 14th July - 19th September				
July	24th		Region Winter Sports	\$2.00
		4 - 6	Swimming Program	\$20.00
August	8th	1	Melbourne Museum	\$30.00
	13th	4, 5 & 6	District Athletics	\$3.00
	28th	6	District Basketball	\$3.00
September	3rd	P - 6	Nexus Show "Papa Glack"	\$5.00
	4th	6	Division Basketball	\$3.00
	9th	4 - 6	Division Athletics	\$2.50
Term 4 4th October - 19th December				
October	4th	4 - 6	Region Athletics	\$2.50
	13th - 15th	3	Allambee Camp	\$175.00
	15th - 17th	4	Allambee Camp	\$175.00
	24th	P - 6	School Photos	
November		6	PE Camp at Rawson	\$180.00
		Prep	Zoo Trip	\$35.00
		6	Melbourne 'One Day Fun Day'	\$50.00
December	19th - 23rd	5 & 6	HPV, Maryborough	
	12th	6	Transition Lunch	
	18th	P - 6	Glen Cromie Park	\$5.00

Please Note:

* All excursion dates are still to be confirmed.

* Camp dates are already booked.

* Shows are to be conducted at school.

* Additional 'small cost' programs may be included during 2014 as we are notified of their availability.